

## G1045 90° Peel Fixture - Assembly Instructions

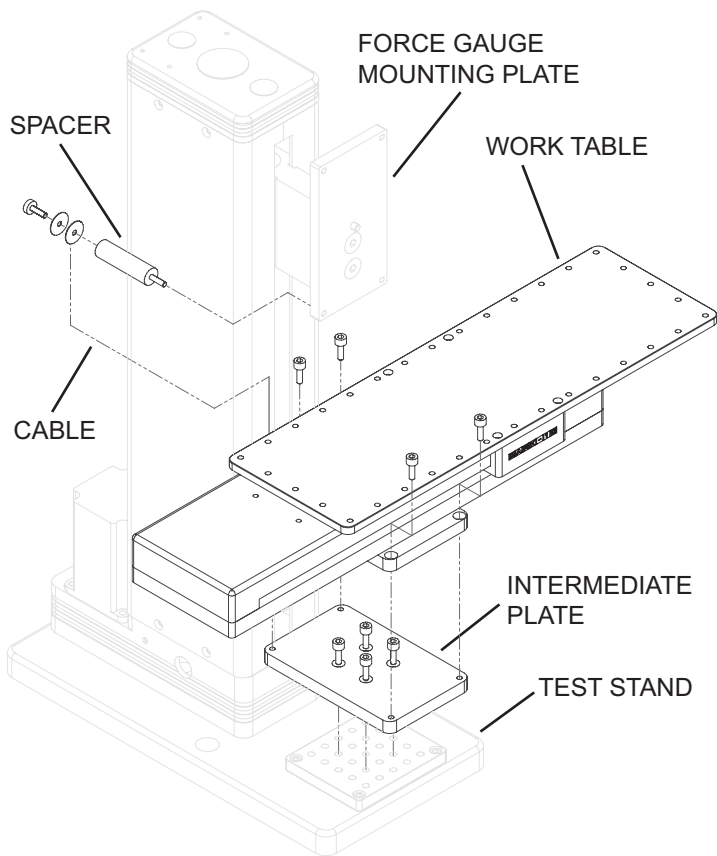

The G1045 90° peel fixture is designed to be mounted to a Mark-10 test stand. The illustration at left depicts proper assembly. Please follow these instructions:

1. Mount the intermediate plate to base plate on the test stand with four socket head screws.
2. Mount the fixture onto the intermediate plate with four socket head screws.
3. Insert the threaded male end of the spacer into the lower left hole of the force gauge mounting plate. Mount a force gauge to the plate with this spacer and three other thumb screws (provided with the test stand)
4. Pull the cable from the rear of the fixture up to the spacer area.
5. Place the cable between the two washers and fasten the thumb screw to the spacer, in order for the washers to clamp the cable. Tighten the thumb screw only after positioning the work table as required for the test.
6. If the G1045-1 limit switch option has been purchased, plug the cable into the connector adjacent to the motor on the test stand. Before regular use with the test stand, check to ensure the limit switch is operational by manually moving the work table horizontally to its limit of travel. Verify that the test stand stops at this point.

The fixture is now ready for use.

**MARK-10**